

Mtk = 300 Nm

Mts = 440 Nm

GIUNTI STERZO - STEERING SHAFTS

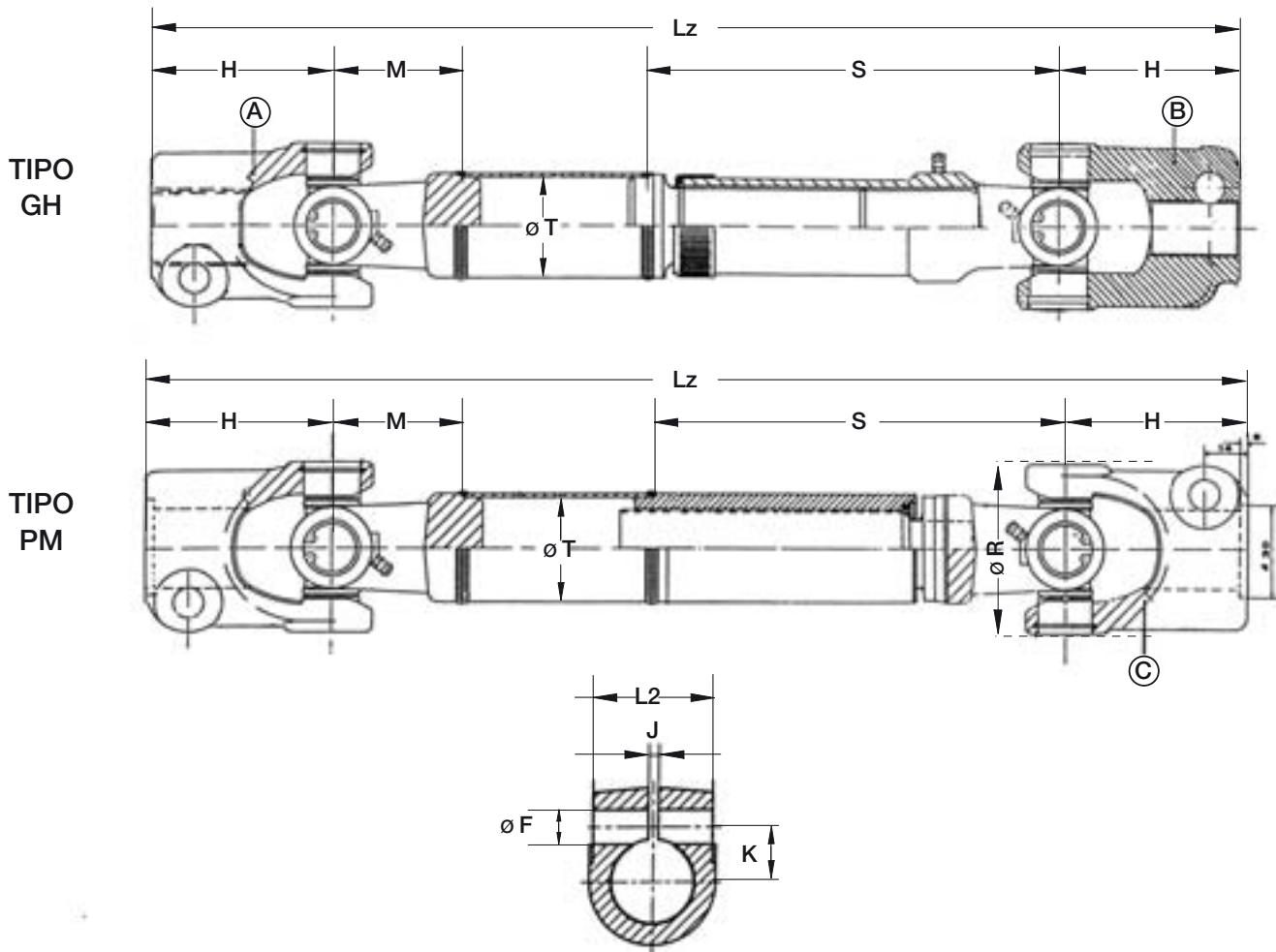

DATI TECNICI - TECHNICAL DATA

TIPO	S	La	Tubo Ø T	M	Ø R	Profilo innesto
GH	148	+60	34 x 2,5	41	59	27 x 23 z16
PM	275	+100/200	40 x 2,5	47		

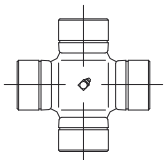

Crocera / Universal joint
Dimensioni = 19 X 48

								Lz min.	
FORCELLA CON MORSETTO	H	L2	K	J	Ø F	β max	GH	PM	
1 X 54 ZGN715 (A)	50	35	16,8	3	10,4	45°	340	440	
1 X 79 ZGN 715 (B)	50	35	11,8	3	10,4	45°	340	440	
Z35; Mod. 0,75; Ø est. 27,30 (C)	60	35	14,2	3	8,5	45°	360	450	